

## BAT-250 Battery Tester Users Manual

### Limited Warranty and Limitation of Liability

Your Amprobe product will be free from defects in material and workmanship for one year from the date of purchase, unless local laws require otherwise. This warranty does not cover fuses, disposable batteries or damage from accident, neglect, misuse, alteration, contamination, or abnormal conditions of operation or handling. Resellers are not authorized to extend any other warranty on the behalf of Amprobe/Beha-Amprobe. To obtain service during the warranty period, return the product with proof of purchase to an authorized Amprobe/Beha-Amprobe Service Center or to an Amprobe/Beha-Amprobe dealer or distributor. See Repair Section for details. THIS WARRANTY IS YOUR ONLY REMEDY. ALL OTHER WARRANTIES - WHETHER EXPRESS, IMPLIED OR STATUTORY - INCLUDING IMPLIED WARRANTIES OF FITNESS FOR A PARTICULAR PURPOSE OR MERCHANTABILITY, ARE HEREBY DISCLAIMED. MANUFACTURER SHALL NOT BE LIABLE FOR ANY SPECIAL, INDIRECT, INCIDENTAL OR CONSEQUENTIAL DAMAGES OR LOSSES, ARISING FROM ANY CAUSE OR THEORY. Since some states or countries do not allow the exclusion or limitation of an implied warranty or of incidental or consequential damages, this limitation of liability may not apply to you.

### Repair

All test tools returned for warranty or non-warranty repair or for calibration should be accompanied by the following: your name, company's name, address, telephone number, and proof of purchase. Additionally, please include a brief description of the problem or the service requested and include the test leads with the meter. Non-warranty repair or replacement charges should be remitted in the form of a check, a money order, credit card with expiration date, or a purchase order made payable to Amprobe/Beha-Amprobe.

### In-Warranty Repairs and Replacement – All Countries

Please read the warranty statement and check your battery before requesting repair. During the warranty period any defective test tool can be returned to your Amprobe/Beha-Amprobe distributor for an exchange for the same or like product.

### Non-warranty Repairs and Replacement – United States and Canada

Non-warranty repairs in the United States and Canada should be sent to an Amprobe Service Center. Call Amprobe or inquire at your point of purchase for current repair and replacement rates.  
USA:

## BAT-250 Battery Tester

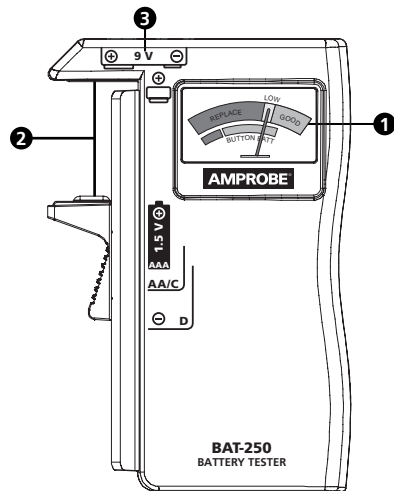

- 1 Battery condition display
- 2 1.5 V battery test terminal
- 3 9 V battery test terminal

### SYMBOLS

	Caution! Refer to the explanation in this Manual
	Complies with European Directives
	Conforms to relevant Australian standards.
	Do not dispose of this clamp meter as unsorted municipal waste. Contact a qualified recycler for disposal.

### ⚠ WARNING and PRECAUTIONS

- Do not operate this instrument in the presence of gasoline, natural gas, propane, or in other combustible atmospheres.
- The BAT-250 is intended to indicate general battery condition and will not predict remaining battery life.
- Test only ONE battery at a time.
- For indoor use only. Do not modify or disassemble.
- To verify the battery tester's operation, first test on a new, fully charged battery.
- Keep test time as short as possible to avoid unnecessary battery drain.

### OPERATION

#### Reading The Meter

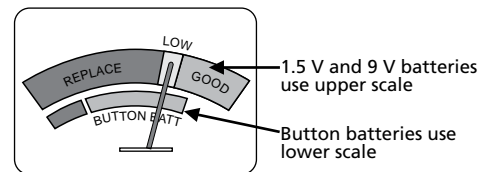

	REPLACE: Battery is weak and should be replaced.
	LOW: Limited power left in the battery. Replacement is recommended.
	GOOD: Battery is fully charged with adequate power.

### ⚠ Caution

- Insert a new battery in the Tester to ensure accurate operation before battery tests.
- To test the battery, note the polarity sign marked in the Tester then hold the battery as appropriate (see examples at right).



Testing 1.5 V battery (AAA, AA, C, D)

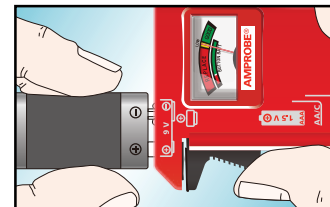

Testing 9-volt battery

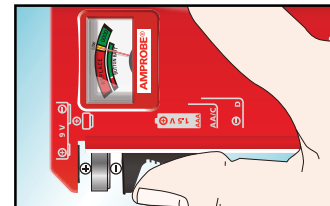

Testing 1.5 V button / watch battery

Testing capability (battery sizes): 9 V, AAA, AA, C, D and 1.5 V button/coin/watch battery.