

**UNION**

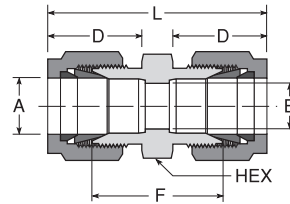
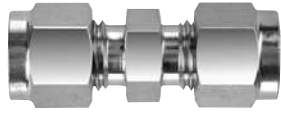

PART No.	A Tube OD	Hex Tube Nut	D	E Min Orifice	F	L OAL	Hex Body
DUA-1-*	1/16"	5/16"	0.44	0.05	0.69	0.99	5/16"
DUA-2-*	1/8"	7/16"	0.60	0.09	0.88	1.40	7/16"
DUA-3-*	3/16"	1/2"	0.63	0.12	0.95	1.47	7/16"
DUA-4-*	1/4"	9/16"	0.70	0.19	1.03	1.61	1/2"
DUA-5-*	5/16"	5/8"	0.73	0.25	1.11	1.69	9/16"
DUA-6-*	3/8"	11/16"	0.76	0.28	1.19	1.78	5/8"
DUA-8-*	1/2"	7/8"	0.86	0.41	1.22	2.02	13/16"
DUA-10-*	5/8"	1"	0.86	0.50	1.25	2.05	15/16"
DUA-12-*	3/4"	1 1/8"	0.86	0.62	1.31	2.11	1 1/16"
DUA-14-*	7/8"	1 1/4"	0.86	0.72	1.37	2.17	1 3/16"
DUA-16-*	1"	1 1/2"	1.04	0.88	1.59	2.58	1 3/16"

\* Add Suffix "SS" for 316 Stainless Steel or "B" for Brass.

**AN 37° FLARE UNION**

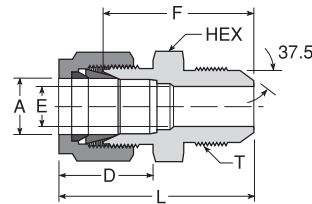

PART No.	A Tube OD	Hex Tube Nut	D	AN Tube Size	T Straight Thread	E Min Orifice	F	L OAL	Hex Body
DUC-2-2-*	1/8"	7/16"	0.60	1/8"	5/16"-24	0.09	0.99	1.24	7/16"
DUC-2-4-*	1/8"	7/16"	0.60	1/4"	7/16"-20	0.09	1.12	1.38	1/2"
DUC-4-4-*	1/4"	9/16"	0.70	1/4"	7/16"-20	0.18	1.19	1.48	1/2"
DUC-5-5-*	5/16"	5/8"	0.73	5/16"	1/2"-20	0.23	1.22	1.52	9/16"
DUC-6-4-*	3/8"	11/16"	0.76	1/4"	7/16"-20	0.28	1.27	1.56	5/8"
DUC-6-6-*	3/8"	11/16"	0.76	3/8"	9/16"-18	0.28	1.27	1.56	5/8"
DUC-8-8-*	1/2"	7/8"	0.86	1/2"	3/4"-16	0.40	1.40	1.81	13/16"
DUC-10-8-*	5/8"	1"	0.86	1/2"	3/4"-16	0.50	1.44	1.84	15/16"
DUC-10-10-*	5/8"	1"	0.86	5/8"	7/8"-14	0.48	1.54	1.95	15/16"
DUC-12-12*	3/4"	1 1/8"	0.86	3/4"	1 1/16"-12	0.61	1.74	2.14	1 1/8"
DUC-16-16-*	1"	1 1/2"	1.04	1"	1 5/16"-12	0.89	1.94	2.43	1 3/16"

\* Add Suffix "SS" for 316 Stainless Steel or "B" for Brass.

Dimensions are provided in inches and are for reference only, subject to change. Dimensions shown are with the nut in the